

# ALUMA ROLLBACK<sup>®</sup>

Aluma Systems Rollback is a flexible solution that improves safety and efficiency for crane handled climbing formwork.



At Work For You™



At Work  
For You™

## Climbing Formwork

Aluma Roll-back system was design to thrive in vertical applications. The integration of standard Aluma Gang increases on-site equipment utilization and reduces rental rates.

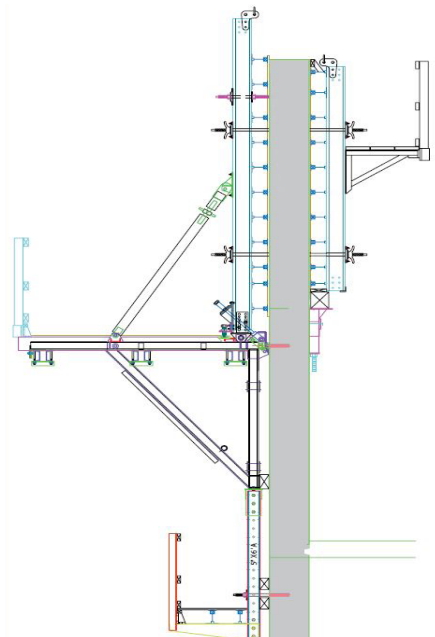

# ALUMA ROLLBACK®



Cardinals Stadium, Phoenix, AZ. Kiewit Western Co. used the Aluma Systems wide Platform Rollback to form one of the stadium's 178-foot super columns.

## Product Benefits

### ROLLBACK®

Compatible with Aluma Gang, Hand Set Panels, Steel Walers and Aluma Beams

Can be used as a platform only, or in combinations with wall forms

Includes guardrail posts, plumbing brace and leveling bolt

Wall forms can easily be rolled away from the concrete wall by hand, 700 mm clear of wall

Easily connected trailing walers and walkways for finishing the concrete wall and removing the previous landing bolt

# ALUMA ROLLBACK<sup>®</sup>

## Technical Data

Product Description	System
Materials	Painted steel
Capacity / Load	Varies, application specific
Weight	280 kg, typical application
Manipulation	Crane handled
Application Range	Can be used independent of wallforms
Relevant Standards	Meets ANSI A10.9, CAN/CSA S269.3-M92
Special Features	<ul style="list-style-type: none"><li>• Integrated guard rails</li><li>• Minimal component system</li><li>• Leveling bolt and plumbing brace</li><li>• Traveling platform for worker access</li><li>• One sided applications</li></ul>

## ► Application & Use

- Roll-back, Tilt-back and hydraulic protection and platform applications
- Climbing Forming Applications
- Commercial Applications
- Industrial Applications
- Infrastructure Applications