

DECK

The DECK is a true modular system, that at its core is light and versatile, with excellent exposed concrete finishes.



At Work For You™



At Work
For You™

Heavy-Duty Slabs

DECK horizontal formwork system utilizes both panels and beam & ply for a truly flexible system capable of complex geometries while maintaining a smooth finish.

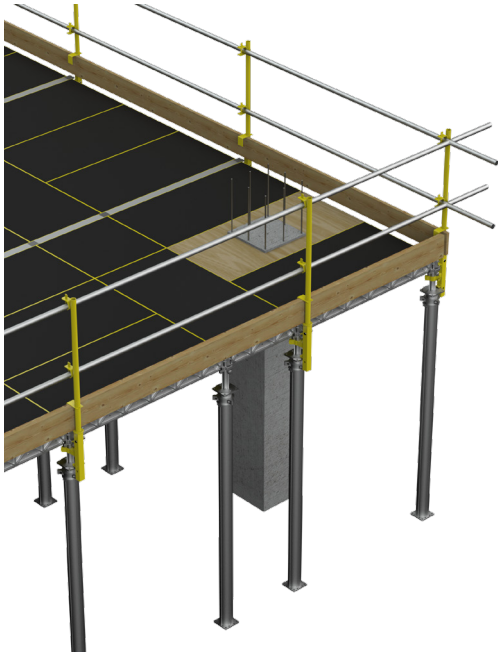

DECK



The striking system allows equipment to be recovered without falling to the floor, contributing to worker's safety. Direction of beams can be changed utilizing the 90° assembly, maximizing the flexibility. Fully integrated guardrail system.

Product Benefits

DECK

The striking system allows equipment to be recovered without falling to the floor, contributing to worker's safety

Direction of beams can be changed utilizing the 90° assembly, maximizing the flexibility

Fully integrated guardrail system

Transversal beam allows grid to be erected prior to panel installation

DECK

Technical Data

Product Description	Large Frame Wall Formwork
Standard Grid Size (m)	1.5 x 2.32 (59 x 91 in)
Panel Widths (m)	0.375 0.75 (14.74 29.5 in)
Panel Lengths (m)	0.75 1.5 (29.5 59 in)
Primary Beam (m)	1.57 2.32 (62 91 in)
Secondary Beam (m)	0.75 1.5 2.075 (29.5 59 81.7 in)
Panel Lining Types	HDO Plywood
Form Lining Thickness	9 mm (0.35 in)
Maximum Panel Weight	15.4 kg (34 lb)
Max. Slab Thickness	40 cm (15.75 in)
Relevant Standards	Meets ANSI A10.9, CAN/CSA S269.1-M92
Special Features	<ul style="list-style-type: none">• Transversal beam allows grid to be erected prior to panel installation• Flush transition from panel to plywood• Quick release 4-way drop head

▶ DECK Integrates with:

- Aluminum Jack complete integration