

# SAFESCREEN®

SAFESCREEN is a perimeter climbing protective system used for full work floor enclosure as well as edge and weather protection.

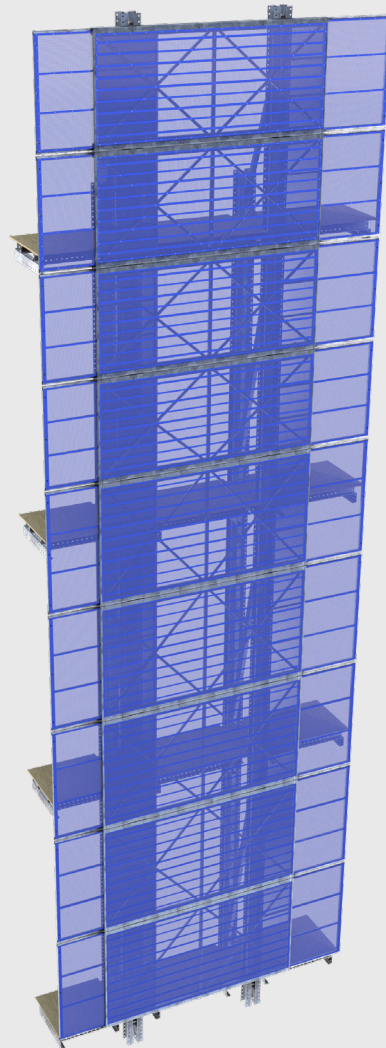

At Work For You™

**Aluma** SYSTEMS  
BY BRAND SAFWAY

# Prioritizing Safety

SAFESCREEN® is an innovative rail climbing edge protection system ideal for projects over ten stories high. Protecting operatives from falls, weather conditions and also providing a useful working platform which extends beyond the slab edge.



▶ Improved on-site and public safety due to full enclosure of the working environment

## ▶ Product Benefits

SAFESCREEN®
Improved on-site and public safety due to full enclosure of the working environment
Multiple floor protection with optional vertical extension
Providing a protective screen for workforce at high levels
With various shield options made of translucent, solid or perforated formworks, grids or panels
Complex architecture easily accommodated
Choice of cladding, colors and brand display for marketing and advertising purposes
Nearly all parts can also be rented
Pre-assembly options for confined site conditions available
The space required for storage and assembly on the construction site is comparatively small
Low dead weight accelerates the assembly process
Lightweight system for easy installation, lifting with crane or hydraulics



▶ Multiple floor protection with optional vertical extension



▶ Complex architecture easily accommodated

# High-Rise Construction

Most commonly the sections are designed for approx. 3.00 m floor to floor; however, they can also be designed for floors from 2.80 m to 4.30 m providing full protection and access platforms to completed “Dry” and new under construction “Wet” levels.

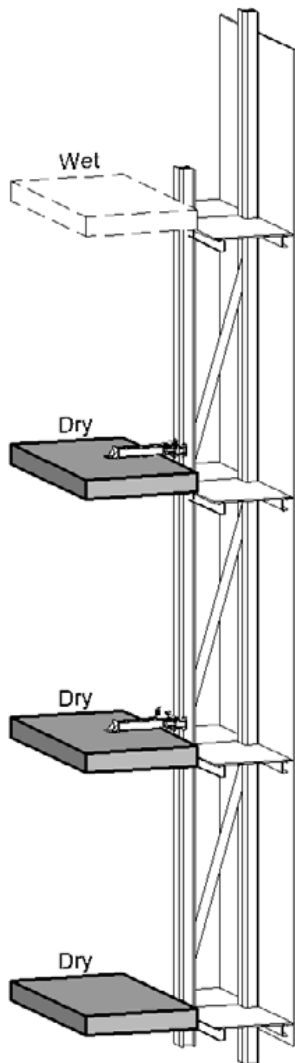

- 4 Platforms (3D+1W)  
single cantilever

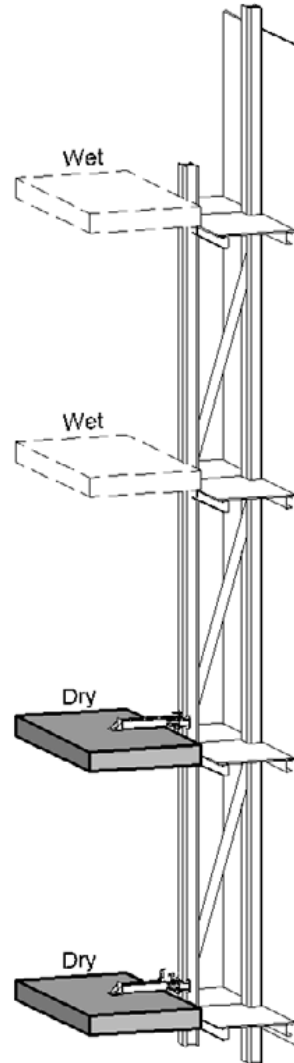

- 4 Platforms (2D+2W)  
double cantilever

# Technical Data

Product Description	Perimeter Climbing Protective System
Unit dimensions	4.60 m x 12 m typical
Weight	1.50 – 3.70 tonnes
Manipulation	110 V hydraulics   Crane
Transportation	No requirement for special wide load
Panels	Solid steel sheeting   Perforated sheeting   GRP translucent sheeting
Application	From second floor
Suitability	Variable building shapes
Relevant standards	BS 5975   EN 12811   EN 1993
Special features	<ul style="list-style-type: none"><li>• adjustable cladding panels</li><li>• folding / extending platform</li><li>• self climbing</li><li>• simple to assemble and install</li><li>• can be built on and off site and adapted for standard transport</li><li>• used on reinforced, post tension and precast slabs</li><li>• Loading platform size – standard approx. 2.10 x 2.70.</li><li>• Other sizes also available with max width approx. 2.70 m, length 5.00 m</li></ul>

## USA

Atlanta, GA  
T 404.699.0979

Sacramento, CA  
T 530.662.5245

Fontana, CA  
T 909.440.0051

Houston, TX  
T 281.860.1900

Tampa, FL  
T 813.626.1133

Seattle, WA  
T 425.251.0270

Baltimore, MD  
T 301.937.5090

Gilberts, IL  
T 847.426.4400

Linden, NJ  
T 732.396.1269

Las Vegas, NV  
T 773.617.9657

## CANADA

Toronto, ON  
T 905.669.5282

Calgary, AB  
T 403.259.2600

Bolton, ON  
T 905.857.8562

Coquitlam, BC  
T 604.472.8000

Montreal, QC  
T 514.383.1985

Sidney, BC  
T 250.652.9409

Edmonton, AB  
T 780.440.1320

## Aluma.com

Photos and diagrams are illustrative only. All products and equipment shall be used or offered for sale only where permitted by law or governmental regulations, codes or ordinances and shall be used in strict conformity therewith and for the purposes and in the manner as may be prescribed therein and in conformity with safe practice. Specifications of products and equipment shown herein are subject to change without notice.

Serious injury may result if you fail to use safe practice in the erecting, dismantling or use of mast climbing work platforms, scaffolding, shoring and/or forming equipment. Erectors, dismantlers and users must be familiar with and follow current laws and regulations, safe practice and the Safety Rules and Instructions. Individuals using this equipment must be instructed in these requirements. Safety Rules and Instructions pertaining to the products shown herein are provided upon sale or rental of equipment. Additional copies or further information shall be provided upon the customer's request. It is important to note that current OSHA regulations require the use of guardrail systems and/or fall-protection devices at all working levels, open sides, and at all other openings on platforms and work areas above certain heights, as specified by OSHA. In all cases, where a worker is exposed to a fall hazard in the use of this equipment, guardrail systems, where appropriate, or other personal fall-protection devices, must be utilized. Means of access must be made available by the customer to all locations where people are expected to work. Materials for the provision of such means of access may be job-built by the customer or, at the customer's option, be obtained through Aluma Systems or other suppliers. Aluma Systems will, at the customer's request, consult on an alternative means of access.